

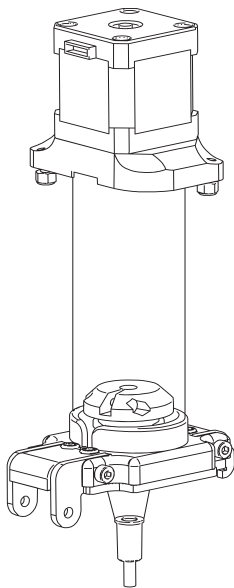

TOOLHEADS

Technical Specification

Thick Paste Extruder Toolhead



SPECIFICATION

Construction:	3 mm aluminum base with ABS printed parts
Nozzle:	2 mm, 4 mm
Motor:	Nema 17 stepper motor
Default work speed:	10 mm/s (depends on the material)
Extrusion:	Direct Drive
Work area:	up to 250 x 235 x 165 mm (without covers)
Recommended printing resolution:	2 mm layer height (2000 microns)
Supported printing resolution:	0.5 - 4 mm layer height (500 - 4000 microns)
Material capacity:	100 ml
Extruder dimensions:	90 x 55 x 271 - 380 mm
Materials:	ceramics, chocolate spread, chocolate and sugar toppings, cookie dough

